

FACT SHEET

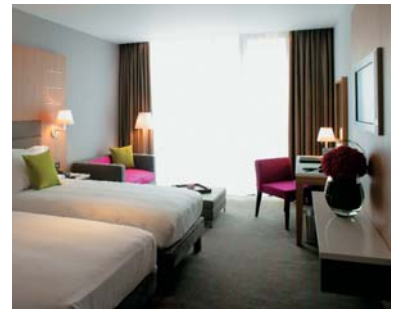

Hotel Information

- Newly built 4 star superior hotel, both elegant and contemporary in its style

Rooms

- 150 stylish guest rooms including Business Class rooms, Junior Suites, One Bedroom Suites and a stunning Presidential Suite. Accessible rooms also available
- In room amenities include; complimentary internet access, flat-panel LCD TV, pay movies, direct dial telephone, hairdryer, iron and ironing board, tea/coffee making facilities, minibar, laptop safe, individual climate control, dry cleaning and laundry service, separate bath and shower
- Executive Floor, suites with private balcony, private lift, access to rooftop Terrace with panoramic views of Dublin City

Dining

- Verres en Vers, a modern and traditional style French Brasserie, with seating facilities for 100 guests, will serve fresh food using both local and French ingredients. Guests can enjoy a range of French Wines, Champagnes, Aperitifs & Digestifs
- Super Buffet Breakfast
- Sure, a stylish all-day lounge and bar is very much the modern day interpretation of a style bar that just happens to be Irish. Sure bar menu includes all day breakfast and afternoon tea.

Location

- Located in the heart of Dublin city centre; 5-10 minutes walk from Dublin's famous shopping and theatre district; St. Stephen's Green, Grafton St., O'Connell St. and Henry St.
- 10 minutes walk from the IFSC, Dublin's main business district
- Surrounded by a wide range of tourist attractions
- 12 km from Dublin Airport and 3 km from Dublin Port

Meetings & Events

- 10 meeting rooms including 2 executive boardrooms, 4 dedicated meeting rooms, 1 video conferencing suite and 3 corporate syndicate rooms all with natural day light
- 1 ballroom/conference room which can hold up to 400 delegates theatre style and can be divided into 3 separate sections with a spacious pre function area directly outside.
- Executive reception/meeting room and bar on the 7th floor
- Landscaped roof top terrace ideal for BBQ's and outdoor events for up to 200 people
- State of the art equipment in all meeting rooms

Services

- Fully air-conditioned
- Complimentary internet access throughout the hotel for hotel guests
- Concierge Services and Car Parking

Radisson SAS Royal Hotel

Golden Lane, Dublin 8, Ireland
Tel: +353 | 8982900, Fax: +353 | 8982901
info.royal.dublin@radissonsas.com
royal.dublin.radissonsas.com

Conference & Meeting Facilities

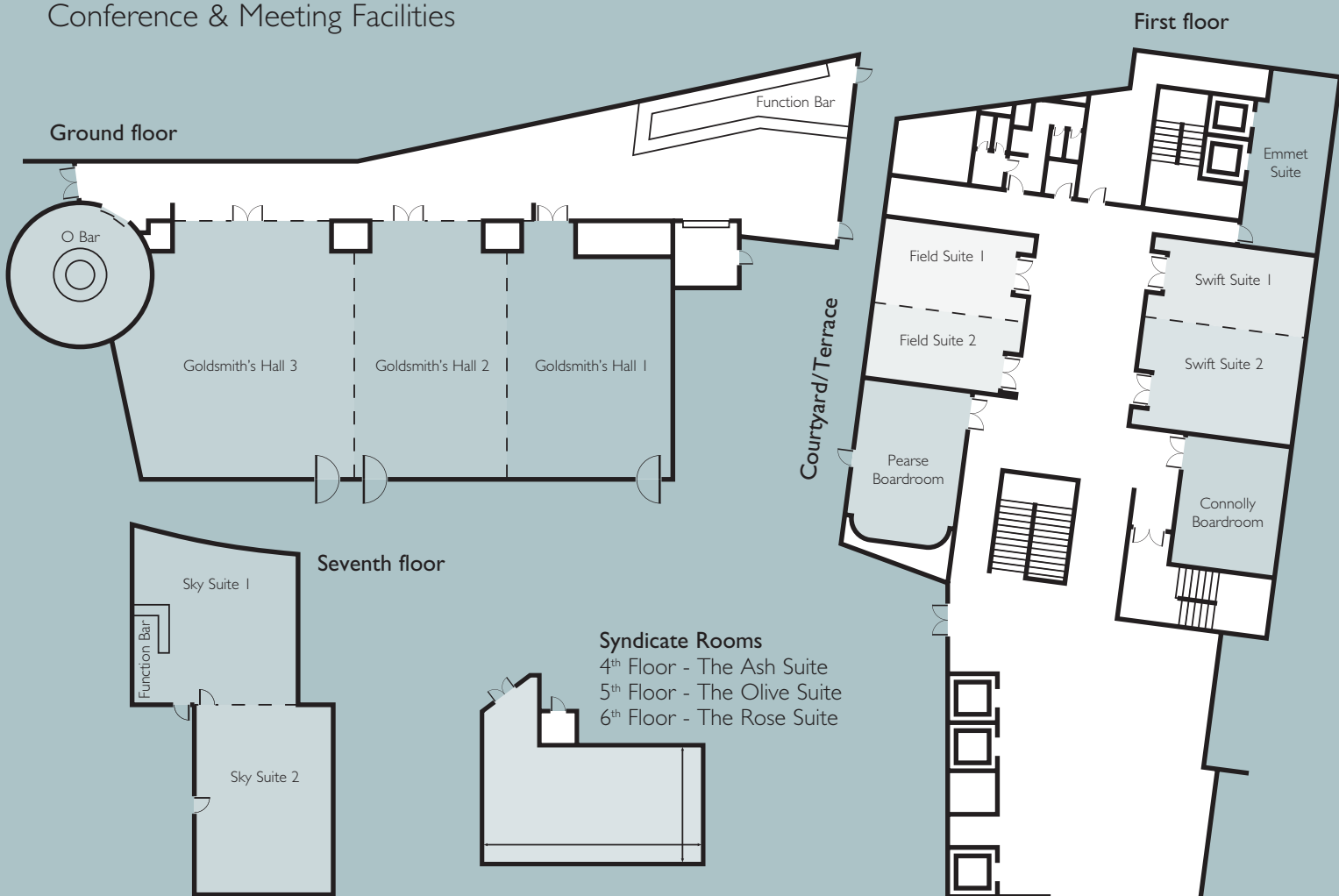

		Theatre style	Classroom style	Boardroom style	U-shape style	Hollow Square style	Banquet style	Cabaret style	Reception style	Floor area (sqm)	Ceiling height (m)	Length and Width (m)	Power Points	Natural daylight	Lighting	Air conditioning
Ground floor	Pre-Conference Area	-	-	-	-	-	-	-	100	67	3,9	8 x 29	✓	✓	✓	✓
	Goldsmiths Hall 1	112	72	-	35	46	80	42	110	111	3,9	13 x 8.5	✓	-	✓	✓
	Goldsmiths Hall 2	112	66	-	35	46	80	42	110	109	3,9	13 x 8.4	✓	-	✓	✓
	Goldsmiths Hall 3	152	60	-	32	46	110	56	150	156	3,9	13 x 12	✓	✓	✓	✓
	Goldsmiths Hall 1+2	240	132	-	49	74	170	90	220	220	3,9	12 x 16.9	✓	-	✓	✓
	Goldsmiths Hall 2+3	304	132	-	60	74	190	112	260	264	3,9	13 x 20.4	✓	✓	✓	✓
	Goldsmiths Hall 1+2+3	400	216	-	-	-	270	168	370	376	3,9	28.9	✓	✓	✓	✓
	O Bar	-	-	-	-	-	-	-	30	-	-	-	✓	✓	✓	✓
First floor	Pearse Boardroom	-	-	16	-	-	-	-	-	42	2,8	5.7	✓	✓	✓	✓
	Connolly Boardroom	-	-	12	-	-	-	-	-	52	2,8	9 x 5.8	✓	✓	✓	✓
	Swift Suite 1	30	24	18	16	20	12	10	35	46	2,8	5.9	✓	✓	✓	✓
	Swift Suite 2	45	28	18	18	24	32	20	50	31	2,8	4.1	✓	✓	✓	✓
	Swift Suite 1+2	70	52	28	24	36	50	35	80	34	2,8	4.4	✓	✓	✓	✓
	Field Suite 1	30	18	18	16	20	12	10	35	34	2,8	4.5	✓	✓	✓	✓
	Field Suite 2	25	18	18	16	20	12	10	30	80	2,8	10.1	✓	✓	✓	✓
	Field Suite 1+2	55	36	24	24	36	40	28	60	65	2,8	8.5	✓	✓	✓	✓
	Emmet Suite	-	-	12	-	-	-	-	-	34	2,8	4	✓	✓	✓	✓
	Terrace Garden	-	-	-	-	-	-	-	200	302	-	-	✓	✓	✓	✓
Fourth floor	The Ash Suite	-	-	6	-	-	-	-	-	39	2,6	4.4	✓	✓	✓	✓
Fifth floor	The Olive Suite	-	-	6	-	-	-	-	-	39	2,6	4.5	✓	✓	✓	✓
Sixth floor	The Rose Suite	-	-	6	-	-	-	-	-	39	2,6	4.6	✓	✓	✓	✓
Seventh floor	Sky Suite 1	-	-	14	-	-	-	-	30	77	2,6	7.4 x 8.4	✓	✓	✓	✓
	Sky Suite 2	-	-	16	-	-	-	-	50	76	2,6	9 x 8.4	✓	✓	✓	✓
	Sky Suite 1+2	-	-	-	-	-	-	-	80	153	2,6	9 x 8.4	✓	✓	✓	✓